

LILA West Valley

Back to school plan for PS to 5th

THE IMPORTANT ROLE OF FAMILIES

Families play a vital role in maintaining safety on campus. The number one safety measure is to keep a child home if they are sick. We want to work with families to support their child's adherence to safety measures on campus and home. To support this effort, before the start of school, we will provide helpful information and orientation and training materials to help transition students to a COVID-safe campus. We understand that there are families with higher risk members in their households. As a community prioritizes health and safety, and we must all do our part to adhere to state health recommendations and regulations to control transmission and potential future outbreaks. Moreover, there may be times when we ask families to comply with broader safety measures, and we much appreciate your cooperation in this regard. Please note that the following steps are intended to reinforce and re-emphasize the LILA's back to school policy and protocols document, which must be followed.

COMMUNITY EXPECTATIONS

All members of the LILA School community have a shared responsibility to prevent the spread of illness when they are aware or suspect that they have contracted a contagious disease. All members of our school community must remain committed to the safety policies and procedures listed in this and future communications to help keep students, staff, and faculty safe. By enrolling your child at LILA, you agree to the following requirements: "Follow Federal, State, and Local Orders. All families are expected to adhere to the directives of applicable federal, state, and local government health departments, including the CDC, regarding social distancing in public and other measures to reduce the spread of COVID-19. » COVID-19 Testing and Notification.

If your child or someone in your household tests positive for COVID-19, you must notify the school immediately and not bring your child to school.

Stay home if sick. If your child is sick, you are expected to keep them home from school. Stay home if exposed. If anyone in your household has been notified that they were in contact with an individual infected with COVID-19, you are asked to inform the school. Based on the circumstances, you may be asked to keep your child home from school for 14 days. Refer to the broader LILA back to school policy and protocols.

Temperature Checking: the school will daily check the temperatures of students upon arrival at school. If your child presents with a 100.4 F or higher temperature, your child will not be allowed to enter the campus and be sent home if the temperature develops during the day.

Face Masks. Send your child to school with a face mask every day he or she is attending on-campus classes. Teach your child how to use and remove a face mask properly. If using fabric masks, ensure that your child's mask is cleaned regularly.

Hygiene: Practice and reinforce good hygiene practices at home, particularly the importance of frequent handwashing.

Students' Items: Limit the items your child brings onto campus each day and reinforce policies around sharing food, supplies, and other items with other students.

Medical Forms; Emergency Contacts: Parents must complete and submit all required student medical forms before the first day of school. Parents must provide at least three emergency contacts (parents/guardians included) who can pick up your child from the school within one (1) hour of receiving a call from the school if your child presents with a temperature or becomes ill during the school day.

ENHANCED HEALTH AND SAFETY MEASURES

- **Increased and improved ventilation has been implemented** throughout campus (e.g., open windows, fans, and new recommended HVAC filters) to prevent any virus spread.
- **Enhanced cleaning/disinfecting practices have been implemented.** Daily cleaning practices will be compliant with CDC recommendations, including the types of cleaning products used and the frequency of cleaning. Special attention will be paid to the cleaning of high-touch surfaces throughout the day.
- **Hand hygiene for students and employees will be amplified and reinforced** and follow a regular handwashing and hand sanitizer schedule throughout the day. Hand sanitizer will be available in all classrooms and offices for faculty and staff, and additional handwashing stations have been added to the school. We also highly recommend that families practice and reinforce good hygiene at home, particularly when it comes to frequent and thorough handwashing.
- **Sick policy and enforcement practices will be reinforced.** Rules regarding sick policies for students and employees will be enhanced and strictly enforced to minimize the number of sick people on campus and allow continuity of learning from home for mildly ill or asymptomatic students. More details about this sick policy, including what symptoms to check for and who to notify if sick, will be shared.
- **The school day and our classrooms are also being reimaged to minimize the virus's risk.** In the event of small numbers of infections on campus, this will enable us to have the affected cohort learn from home for two weeks without requiring that the entire campus close for two weeks and revert to distance learning. This planning for safety and durability requires LILA to invest financial resources. A one-time screening will be done on the 1st day of school to cover the last 14 days. Once at campus, the daily screening will be required.
- **Other safe classroom practices:** Teaching methods will be adjusted to minimize shared equipment or learning materials between students; classroom practices will reduce the transfer of objects between home and school and touch other students' personal belongings. We also ask that families limit the items their child brings onto campus each day and reinforce policies around sharing food, supplies, and other items with other students.
- **Self-care and well-being:** Pedagogy and classroom practices will provide attention to student mental health and well-being to build resilience and cope with the stress, or anxiety students may experience in this pandemic context.

- **Physical distancing.** Movement on campus will be controlled and directed to reduce the mixing of students. Students will be seated with 6ft spacing in classrooms to minimize transmission risk. This will reduce the risk of viral transmission.
- **Campus Access:** There will be limited visitor access to buildings. Parents will only be allowed access to campus upon prior appointment and screened upon arrival. Assemblies and large group gatherings will be held virtually.
- **Excursions, camps, and extracurricular activities:** All have been suspended until further notice.

PROTECTION & SAFETY

- Students, staff, and faculty must wear masks at all times
- Reinforced hand washing/sanitizing before/after bathroom use, recess, lunch, and before all transition periods at minimum.
- Air filter in each classroom.
- Hand sanitizer dispensers have been installed in each class.
- Extra hand washing sinks have been installed next to the lunch tables.
- Class sanitization and ventilation are reinforced.
- A/C air filters changed recommended by the health department.
- Touch-less thermometers for fever detection

ACADEMIC PLANNING

While the school will look and feel different from usual in many ways, it will also feel quite the same in that we will support our students' growth and usher them into the school year comfortably with care and attention to their needs. We are also committed to continuing a well-rounded program that fosters academic growth, support health and well-being, and cultivates the development of the whole child.

Class Groupings The class sizes in PS and PK will be in pods of 12. From K to 5th, students will be 6ft away and in stable small cohorts of 12 in each classroom.

Class sizes. Classrooms will be configured to allow for social distancing. To avoid mixing class groups, the movement of students between classrooms will be limited throughout the day. At various times, faculty will move between classrooms or provide remote instruction to a class.

3rd/4th/5th grade: staggered welcome. (Monday:5th / Tuesday and Thursday:3rd / Wednesday and Friday:4th)

Considerations:

Pick-up and drop-offs:

- PS and PK parents will come in on three different entrances (depending on the pods) by car. They are allowed to walk their child to their designated gate, keeping their distance and their masks on.

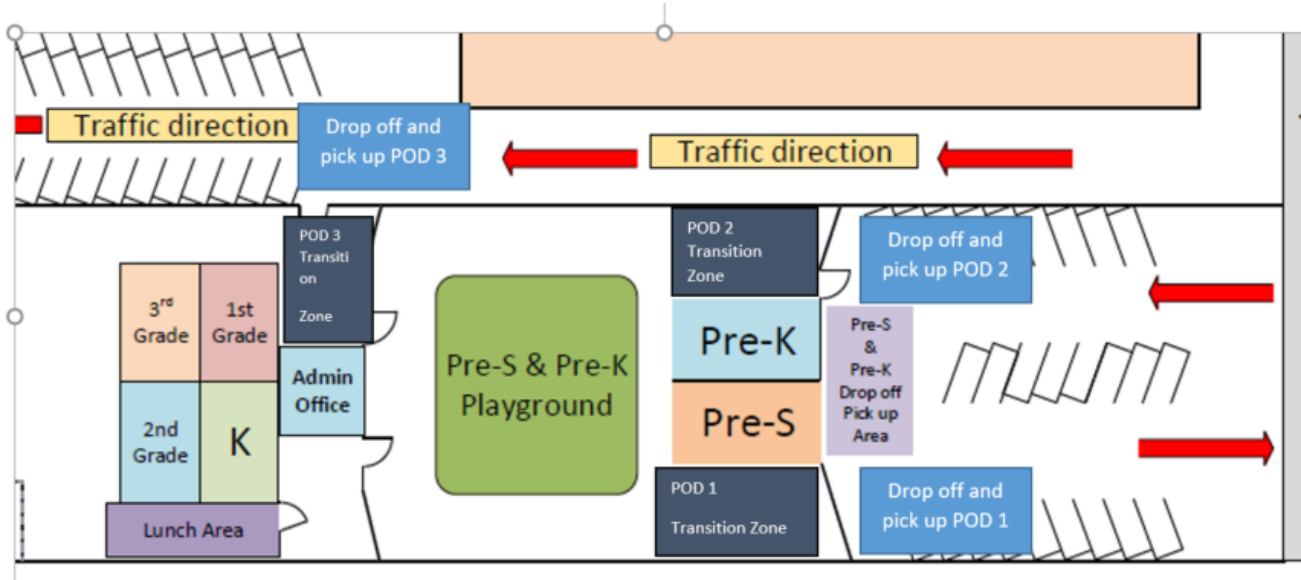

- K, through 5th-grade parents, will drop-off students on a drive-through using the big parking lot as an entrance, following the schedule.

Grade	Drop off time	Pick-up time
All grades	8:00 – 9 am	3:30 to 3:45 pm

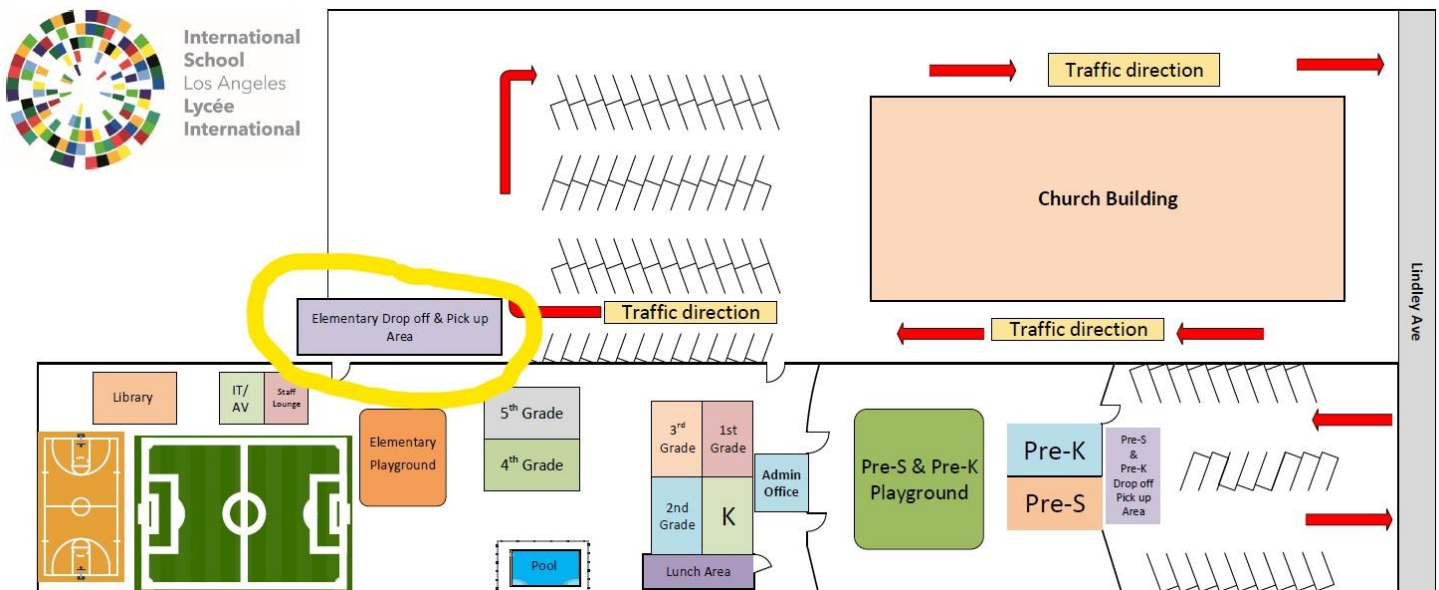

- Temperature checked at entry inside the car before the child disembarks, and checking the health screening confirmation.
- Parents will not be permitted to leave their cars unless by prior appointment.

Other considerations:

- Outside class areas will be installed if the temperatures allow it.

- Students will eat at the work station in the classroom or outside when possible (6ft away from each other)
- Recess areas will be implemented by zoning (see plan)-:

Recess / Lunch Areas per day/After school recess	MONDAY	TUESDAY	WEDNESDAY	THURSDAY	FRIDAY
Zone 1	K	2 nd	1 ST	3 rd	4 th
Zone 2	1 ST	K	2 nd	K	2 nd
Zone 3	5 th	3 rd	4 th	1 ST	K
Zone 4	2 nd	1 ST	K	2 nd	1 ST

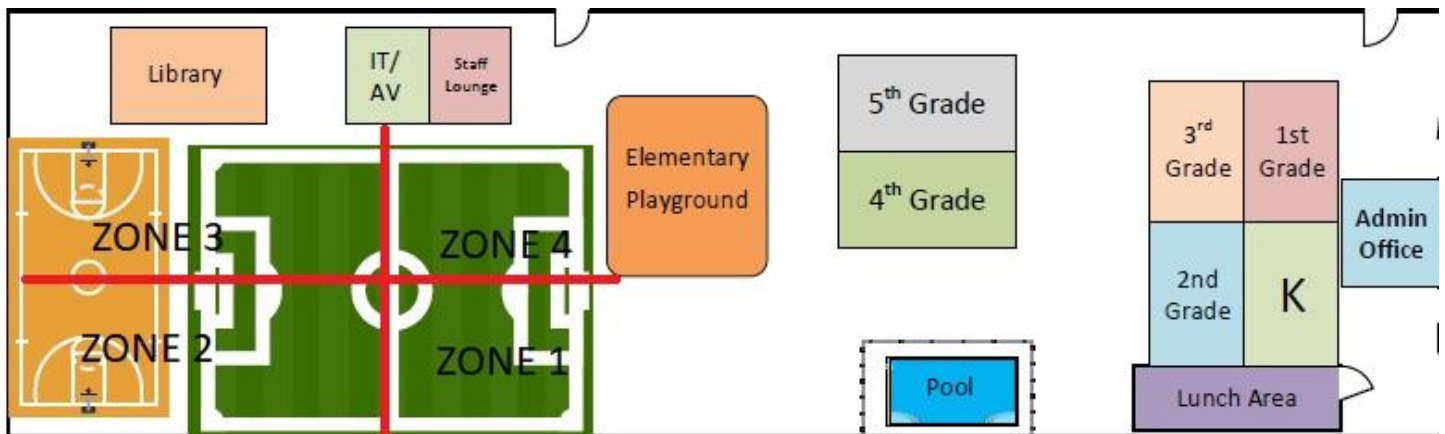

1st Grade classroom photos of space setup

